

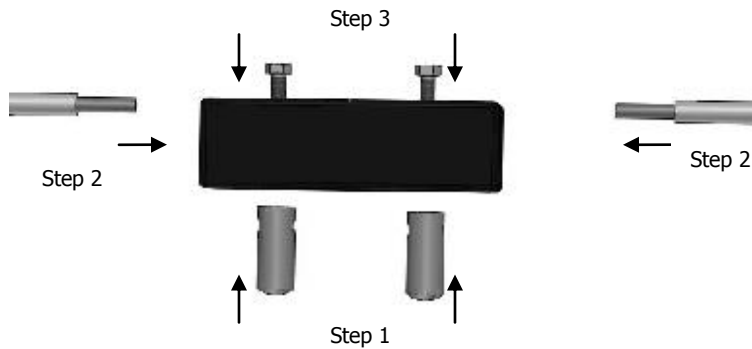

A Safe Fleet Brand

## 6 gauge contact plate

This contact plate is designed to have internal wire connections. Insert bronze contacts into poly blocks so that the holes in the sides line up with the side holes in the poly blocks. Strip  $\frac{3}{4}$ " of sheath off the end of the wire that is to be hooked to the contact plate and twist strands tight together. Insert the exposed end of the wire into the hole in the end of the poly block until wires go into the brass contact and the wire sheath comes up against contact. The sheath should fit snugly inside the poly block. Tighten set screw on top of the poly block. This will lock the bronze contact into the poly block as well as connect the wire to the contact. You should not be able to pull the wire out of the poly block at this time. See diagrams below.

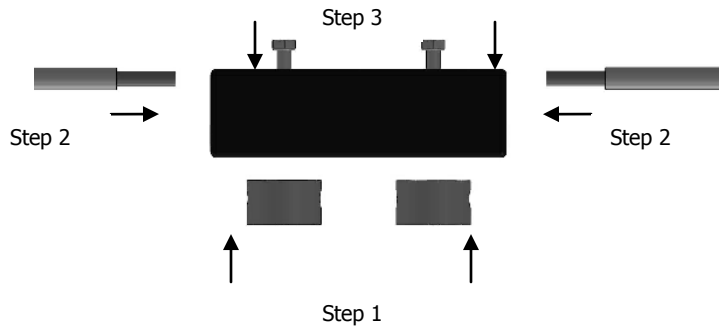

Mount the angle iron by bolting or welding in place. Attach assembled poly blocks to the angle iron as shown below. Note on the side with the springs, only run the nut on until there are 2 threads sticking through the nylock in the nut. **Make sure the wires will not interfere with any thing that may chaff or pinch them.**

